



DEPARTMENT OF EDUCATIONAL & SOCIAL SERVICES

A PROPOSAL PAPER

The following schools are affected by this Proposal Paper:

- **Darvel Nursery School**
- **Darvel Primary School**

This document has been issued by East Ayrshire Council for consultation in terms of the Education (Publications and Consultation etc) (Scotland) Regulation 1981 and Amendment Regulation 1987, 1988, 1989 and 2007.

Any Ordnance Survey map data included within this document is provided by East Ayrshire Council under licence from Ordnance Survey in order to fulfil its public function in relation to this public consultation. Persons viewing this mapping should contact Ordnance Survey Copyright for advice where they wish to licence Ordnance Survey mapping data for their own use.

DISTRIBUTION

A copy of this document is available on the East Ayrshire Council web-site:
www.east-ayrshire.gov.uk

A copy of this document will be provided to:

- The Parent Council, or equivalent, of the affected nursery and school
 - The parents of the children at the affected nursery and school
 - Parents of children expected to attend an affected school within 2 years of the date of publication of this proposal paper
 - The pupils and children at the affected nursery and school
 - The staff, teaching and ancillary, at the affected nursery and school
 - The Community Council
 - Relevant users of the affected nursery and school
 - Community Association
-
- The constituency MSP
 - List MSPs for the area
 - The Constituency MP
 - Sub-Divisional Commander, Strathclyde Police
 - Chief Executive, NHS Ayrshire and Arran
 - Chief Executive Strathclyde Partnership for Transport (SPT)
 - Area Commander, Strathclyde Fire and Rescue
 - Executive Director of Neighbourhood Services, East Ayrshire Council
 - Executive Director of Corporate Support, East Ayrshire Council

A copy of this document is also available from:

Council Headquarters, London Road, Kilmarnock, KA3 7BU

Public libraries in the vicinity of the schools affected

Local area offices in the vicinity of the schools affected

The school(s) affected by the proposal

This document is available in alternative formats or in translated form for readers whose first language is not English. Please apply to the Department of Educational and Social Services, Council Headquarters, London Road, Kilmarnock, KA3 7BU, telephone 01563 576109, e-mail **education.consultation@east-ayrshire.gov.uk**

SUMMARY OF PROCESS FOR THIS PROPOSAL PAPER

1. Consideration by the Cabinet (Education)

This proposal paper has been issued as a result of a decision by the Cabinet (Education) of East Ayrshire Council. This is to seek views on the proposals in this paper. Once the consultation period has passed the Cabinet (Education) will take a decision on whether, or not to implement the proposals.

2. Possible call in by Governance and Scrutiny Committee

Due to the timescales involved exception from the call in process has been sought for the initiation of this consultation exercise.

3. Proposal paper issued to consultees and published on Council Web-site

A copy of this document will then be issued free of charge to the consultees listed on the preceding page.

4. Publication of advertisement in local newspapers

An advertisement will be placed in the relevant local newspapers and if necessary any national newspaper. If necessary, there may be announcements related to the consultation process on the local radio station, West Sound.

5. Length of consultation period

The consultation period lasts for a minimum of 28 calendar days.

6. Public meeting

A public meeting must be held, the details of which are given on the following page.

7. Preparation of consultation report

The authority will prepare a consultative report taking account of all of the representations it has received. This will be published in electronic and printed formats. It will be available on the Council web-site and from Council Headquarters, free of charge. The report will include the Authority's response to any comments it has received, together with any other relevant information, including details of any alleged inaccuracies and how these have been handled.

8. Decision

This report is considered by the Education Cabinet (Education) who will come to a decision. This decision is then subject to the Council's call-in procedures.

Special Note on Corrections

If any inaccuracy is discovered in this proposal paper the authority will inform the person who has notified the inaccuracy of any appropriate action that is being taken, such as reissuing the paper or revising the consultation period if appropriate

PUBLIC MEETING

A Public Meeting will be held to discuss these proposals. Anyone wishing to attend the public meeting is invited to do so. The meeting will be addressed by the Executive Director of Educational and Social Services, or other senior officers of the Council.

The meeting will be an opportunity to:

- Hear more about the proposal
- Ask questions about the proposal
- Have your views recorded so that they can be taken into account as part of the consultation process.

The meeting will be held:

Date: [to be inserted]

Time: from – 7.00pm to 9.00 pm

Venue:

A note will be taken at the meeting of questions and views. This note will be published on the Council web-site, and a copy will be made available on request.

**EAST AYRSHIRE COUNCIL
DEPARTMENT OF EDUCATIONAL & SOCIAL SERVICES**

THIS IS A PROPOSAL PAPER

Proposal:

That pre-5 education at the existing Darvel Nursery School building be discontinued with effect from 30 June 2011, or as soon as possible thereafter.

Further, that Darvel Nursery School, staff and children should relocate to a new building to be constructed in the existing Darvel Primary School grounds, co-located with the refurbished primary school from 01 July 2011, or as soon as possible thereafter.

Report by Executive Director of Educational and Social Services

1. VISION

- 1.1** East Ayrshire Council has an established vision for its school estate which will ensure the delivery of a modern curriculum in school buildings which are suitable for purpose. This vision further states:-

“East Ayrshire Council’s Department of Educational and Social Services: committed to providing choice, maximising opportunity for all, developing the potential of individuals and meeting needs through inclusion”

- 1.2** This statement covers every aspect of the Department’s work including the management and development of educational establishments. The Council’s School Estate Management Plan states that development and improvement in the fabric of school buildings is a key component in the facilitation of the learning and teaching process.

- 1.3** The Council has also approved the Department’s objectives for achieving its aims. These are detailed below:

- reducing surplus capacity
- addressing maintenance issues
- meeting statutory requirements of DDA legislation
- improving property flexibility

- 1.4** The proposals set out in this document will ensure that all these issues are addressed in a manner which will achieve improvements for all learners in Darvel Primary School and Darvel Nursery School whilst also obtaining best value for the Council.

2. BACKGROUND

- 2.1 At its meeting of 6 May 2009 Cabinet considered a report "Capital Investment Programme Update" and agreed a recommendation that:

"subject to the statutory public consultation process the Darvel Primary School extension should include the integration of the existing Nursery School and that the budget for the project be adjusted to accommodate this."

- 2.2 The report further observed:

"A number of options have been considered in relation to the refurbishment/extension of Darvel Primary School. The aim of the option appraisal exercise was to address current deficiencies in property provision to provide an environment for all pupils, staff and parents which supports the delivery of the aspirations for "A Curriculum for Excellence". The options considered covered two basic approaches for addressing these aims, namely:

- (a) Extension to existing Primary School to provide additional classroom accommodation and dining/gym/assembly facilities; and*
- (b) extension to existing Primary School to provide accommodation to allow the Nursery to relocate to the school, additional classroom accommodation and dining/gym/assembly facilities.*

Based on initial discussions with Educational and Social Services staff the preferred option would be to build an extension to the school which would allow the co-location of the Nursery which is currently situated elsewhere in Darvel in outdated accommodation which is not conducive to 21st Century education.

The indicative budget allocation for the project is £3M as per the approved Capital Investment Programme. It is estimated that the option to build a facility to accommodate the Nursery on the school site and provide replacement classroom/gym/dining/assembly facilities would result in costs increasing to over £5M. Until detailed designs are finalised and tenders received it is difficult to quantify more accurately the additional funding required."

(Paragraphs 3.11 to 3.13 of Capital Investment Programme Update, Cabinet, 06 May 2009)

- 2.3 Copies of the report that was submitted to Cabinet on 06 May are available from the Executive Director of Educational and Social Services, Council Headquarters, London Road, Kilmarnock, KA3 7BU or education.consultation@east-ayrshire.gov.uk . They are also available electronically on the Council web-site: www.east-ayrshire.gov.uk.

3. PROPOSAL

3.1 It is therefore proposed that:

That pre-5 education at the existing Darvel Nursery School building be discontinued with effect from 30 June 2011, or as soon as possible thereafter.

Further, that Darvel Nursery School, staff and children should relocate to a new building to be constructed in the existing Darvel Primary School grounds, co-located with the refurbished primary school from 01 July 2011, or as soon as possible thereafter.

4. PRESENT POSITION

4.1 Darvel Nursery School

Darvel Nursery School is housed in separate accommodation in the centre of the village of Darvel in a building of traditional sandstone construction.

Appendix 1 (attached) shows the present site of Darvel Nursery School.

4.2 The nursery school caters for 120 pre-school children, 60 each morning session and 60 each afternoon session. There are currently 110 children enrolled in the nursery school, and at the start of session 2009/10 there will be approximately 103 children enrolled.

4.3 An integrated inspection of education and care at Darvel Nursery School carried out jointly by Her Majesty's Inspectors of Education (HMIe) and the Care Commission in 2005 praised all aspects of the leadership, the very high standards of education and the very good support for children and families offered by the school.

Key strengths highlighted in the report include:

- Welcoming and stimulating environment created by the hard working team
- Happy and confident children who are actively involved in their learning
- High quality of interaction with children to support and extend their learning
- The very good learning experiences for children, with staff providing very good programmes in the five key areas of children's development and learning

The report commented on the accommodation:

"The accommodation provided a welcoming, pleasant and stimulating environment for children.....Very good use was made of available space.....The outdoor play area had been identified as an area for development"

Copies of this report are available from www.hmie.gov.uk or from the nursery school.

- 4.4** Since 1999, East Ayrshire Council has invested £99,500 in necessary maintenance and repairs at Darvel Nursery School. Despite this aspects of the building are less than satisfactory. The building condition report dated April 2009, based on the Scottish Government's "*Condition Core Facts*" guidance for school buildings, accords the building a "C" rating which means that the condition of building is classified as "poor", having major defects and/or not operating adequately. It requires expenditure in excess of £410,000 to bring the existing fabric to an acceptable standard.
- 4.5** In addition, the internal layout of the building presents challenges, which include a layout and features which restrict easy movement between play areas. These would, for example, create difficulties for children or adults with mobility problems.

5.1 Darvel Primary School

5.1.1 Darvel Primary School provides non-denominational education to the village of Darvel and the surrounding area. Appendix 2 (attached) shows the present school delineated area for Darvel Primary School. The present site of Darvel Primary School is shown in Appendix 3.

5.1.2 The school has a planning capacity of 384, with a working capacity of 340. As at September 2008, the school roll is 309.

5.1.3 There has been some refurbishment work undertaken which has considerably improved the internal appearance of the school. The accommodation does however present a number of issues:

- The overall design of the school is of early 20th Century vintage and offers accommodation with restricted flexibility.
- The accommodation is on two levels with no accessible lift, thereby reducing access for children and adults with mobility problems. Even at ground level there are internal flights of stairs reducing access.
- The external fabric of the school has deteriorated markedly over recent years and is in urgent need of refurbishment.
- The building is energy-inefficient.
- The separate dining hall is of poor construction, requiring continual maintenance.

5.1.4 In 2005 Darvel Primary School was inspected by Her Majesty's Inspectors of Education (HMIe). The inspection report pointed to a number of key strengths of the school:

- *"The very good arrangements for pastoral care.*
- *The support from the school board, parent teacher's association and the school's effective links with the wider community.*

- *Pupil's strong sense of pride in the school and their mature approach to accepting responsibility for improving aspects of school life.*
- *The valuable contributions of classroom assistants, clerical and ancillary staff to the quality of education provided by the school.*
- *The effective overall management of support for pupils and the way very good progress was made by pupils with additional support needs."*

The report by HMIE reflected that parents, pupils and staff did not report any concerns with the accommodation. However, HMIE themselves recorded: *"The overall quality of accommodation was fair with some important weaknesses relating to health and safety. The interior of the building was generally bright and attractively decorated. Staff made good use of a separate computer suite to improve the skills of pupils in information and computing technology (ICT), English language and mathematics. Ventilation in some classrooms was poor. A leaking roof led to damage to displays in the classrooms on the upper floor. There was limited access to parts of the school for disabled persons."*

Copies of this report are available from www.hmie.gov.uk or from the nursery school.

While these matters have been addressed, a refurbished building will do much to further improve the accommodation and some of the fundamental buildings and accommodation issues that remain.

5.1.7 Over recent years East Ayrshire, through its projects at Grange Campus, St Joseph's Campus, Shortlees campus, Mauchline Primary School and Nursery Class and the Galston Primary School/Nursery School campus has built a high reputation for school design. These locations have also seen facilities developed for further integrating the life of the school with its local community. The intention would be to apply this good practice and experience to this project.

6. THE PROJECT

6.1 The newly refurbished premises will address the accommodation issues highlighted above.

6.2 Additionally, It is envisaged that the refurbished campus will provide the following for the children, parents and staff of the nursery and school

- A modernised learning environment to suit the needs of both school communities.
- Facilities that are fully suited to the delivery of a Curriculum for Excellence including:
 - Networking for information technology;
 - Purpose built nursery facilities;

- Purpose built features of the design for children with additional support needs including enhanced campus accessibility and bespoke toilet and changing facilities;
- Accommodation compatible to Health Promoting School status;
- A building which is environmentally friendly;
- Facilities that make the best opportunities for sharing facilities and resources between the two schools;
- Such other features as emerge from further consultations with the schools and community and which are cost-effective

6.3 In addition, it is envisaged that the opportunity will be taken for this campus based development to include improved access for the community to the facilities offered by the campus

7. JUSTIFICATION FOR THE PROPOSAL

7.1 Educational Benefits Statement

7.1.1 The likely educational effects of the proposal on:

- (i) the children of Darvel Nursery School.

Children will have access to modernised facilities. These will include flexible learning areas and “designed-in” information technology including “Smart” technology and its equivalents. Using the experience of other recent building projects environmental and sustainable development features can be built into the school to assist learning together with features that support the health promoting school and healthy lifestyle priorities. The refurbished accommodation will increase pride in both establishments and contribute to children and young people’s confidence.

The change will be beneficial for nursery-aged children and those with additional support needs where specialist facilities and design features will be incorporated to meet their needs. It is envisaged that the schools will be able to share resources and facilities thereby maximising the opportunities for young people. All of these features will support effective provision under “The Curriculum for Excellence.”

Careful design will allow the children, pupils and staff of both the nursery and school to enjoy shared use of facilities and resources. This will include opportunities for shared continuing professional development for example on the Curriculum for Excellence, which is a 3-18 programme; additional support needs and nursery-primary transition.

Co-location should ease matters for parents who have children at both establishments delivering and picking up children.

- (ii) other users of the schools’ facilities.

The campus will have improved accessibility to the community. This will be particularly important in terms of Disability Discrimination Act compliance. Wherever possible, school facilities will be available to the community.

- (iii) any children who would in the future (but for implementation) be likely to be enrolled at the nursery

It is envisaged that this campus will be an extremely positive feature of the community, and potentially will attract new population to the area. This will safeguard the future resources and facilities for young people for the foreseeable future.

- (iv) the pupils and children of any other nurseries and schools in the authority's area.

As originally envisaged in the School Estates Management Plan, this proposal represents a strong best value solution that will have general benefits for all young people in East Ayrshire in terms of best use of resources.

7.1.2 Any other likely educational effects of the proposal, if implemented.

It is possible that the building work associated with these proposals may involve some disruption to the life of Darvel Primary School. This may necessitate the use of temporary accommodation or a temporary decant of some or all of the children. Parents will be consulted as any details of the necessity for making such arrangements emerge. It is not envisaged that the Darvel Nursery School will be affected by any such building work. The experience of the Authority is that such arrangements have no detrimental effect on pupil attainment or achievement in either the short or long term.

7.1.3 The educational benefits which will result from implementation of the proposal, if implemented.

In summary, children and the community will be provided with modernised facilities suited to the needs of learning in the 21st Century and which will be, so far as possible future-proofed. The design features will include the considerations of the Curriculum for Excellence. This view is based on experience from recent new-build projects within East Ayrshire and from visits to shared campuses in other authority areas.

8. CONSEQUENCES OF PROPOSALS

- 8.1** The proposals set out in this paper will result in a refurbished and extended set of school buildings on the present site of Darvel Primary School. The staff, parent councils and equivalent and community will be consulted as detailed plans emerge.

- 8.2** Where necessary, any aspect of the implementation of these proposals that impacts on staff will result in consultation with the relevant trade unions and the individuals concerned.
- 8.3** The proposal will result in extensive building work taking place on the present Darvel Primary School campus. During the construction phase, part of the school grounds will be unavailable to young people and the community. The ground area will become available again upon any demolition of the existing buildings.
- 8.4** The new campus will be accompanied by a traffic management scheme which will be subject to consultation with the Roads Department and other relevant agencies.

9. OTHER ISSUES

9.1 Management of Proposals

It is anticipated that the new campus will be complete by August 2011, or as soon as possible thereafter. This will allow the Council to conduct the necessary consultations in accordance with the relevant statutory frameworks.

It is acknowledged that should the proposal be approved and implemented, forward planning will be required from the Education Authority nursery and school senior staff, as a matter of good management practice. This planning is necessary in respect of curriculum delivery, staff management and associated issues.

9.2 Health and Safety

It is not considered that this proposal would result in any additional health and safety risks in respect of the existing building at Darvel Primary School. Children from Darvel Nursery School will not move to the site until building work is completed. Any contractor appointed will be legally and contractually obliged to carry out development work in strict compliance with all necessary Health and Safety requirements.

9.3 Distances

Both establishments are currently sited near Darvel village centre. The distance between them is approximately 0.3 miles. It therefore follows that some families may have additional travelling distance to the nursery as a result of these proposals. Conversely, other families will have their journey to school reduced by an equivalent amount.

9.4 Regeneration issues

Since both establishments are equidistant from the village centre, and since no substantial net shrinkage of either establishment is envisaged by these proposals, there is likely to be any adverse impact on the economic regeneration of Darvel village centre.

10. FINANCIAL IMPLICATIONS

- 10.1** The component renewal costs for Darvel Nursery School are in excess of £410,000 for the same period.
- 10.2** The Cabinet report of 06 May 2009 indicates a figure of over £5M being available for this project. The full cost will be known when a final design has been produced as part of the Full Business case procedures.

- 10.3** The estimated revenue savings are:

Savings from the proposal to co-locate Darvel Nursery School with Darvel Primary School:

Janitation and cleaning £ 7,395

Property costs £11,072

- 10.4** Once building plans are known, there may be decant costs associated with these proposals. Otherwise, there are no additional transport costs arising from these proposals.
- 10.5** It is envisaged that the present buildings on the Darvel Nursery School site will be declared surplus to the requirements of the Department of Educational and Social Services' requirements. Thereafter the future of the site will be determined under the Council's established procedures for considering the future of surplus property.

11. RESPONDING TO THE CONSULTATION

- 11.1** Interested parties are invited to respond to the consultation by making written or electronic submissions on the proposal to the Executive Director of Educational & Social Services, East Ayrshire Council, Council Headquarters, London Road, Kilmarnock KA3 7BU, E-mail: education.consultation@east-ayrshire.gov.uk .
- 11.2** A form is provided at Appendix 5 for the convenience of those wishing to respond. Its use is not however compulsory. However, those wishing to respond are invited to state their relationship with the school – for example, “pupil”, “parent”, “grandparent”, “former pupil”, “teacher in school”, “member of the Community” etc. Responses from the parent councils, staff, and pupil council are particularly welcome.
- 11.3** Those sending in a response, whether by letter or electronically should be know that their response will be open to public scrutiny and may have to be supplied to anyone making a reasonable request to see it. If they do not wish their response to be publicly available, they should clearly write on the document: “I wish my response to be considered as confidential with access restricted to elected members and council officers of East Ayrshire Council.” Otherwise, it will be assumed that the person making the response agrees to it being made publicly available.

12. RECOMMENDATIONS

12.1 It is recommended that the Cabinet agree to adopt for the purpose of consultation the proposal that:

That pre-5 education at the existing Darvel Nursery School building be discontinued with effect from 30 June 2011, or as soon as possible thereafter.

Further, that Darvel Nursery School, staff and pupils should relocate to a new building to be constructed in the existing Darvel Primary School grounds, co-located with the refurbished primary school from 01 July 2011, or as soon as possible thereafter.

- (i) That pre-5 education at the existing Darvel Nursery School building be discontinued with effect from 30 June 2011, or as soon as possible thereafter.
- (ii) That Darvel Nursery School, staff and pupils should relocate to a new building to be constructed in the existing Darvel Primary School grounds, co-located with the refurbished primary school from 01 July 2011, or as soon as possible thereafter.

12.2 It is also recommended that:

- i) interested parties be invited to make written or electronic submissions on the proposal to the Executive Director of Educational & Social Services, East Ayrshire Council, Council Headquarters, London Road, Kilmarnock KA3 7BU, E-mail: education.consultation@east-ayrshire.gov.uk no later than **[to be inserted]**.
- ii) the Executive Director of Educational & Social Services prepares a report on the results of the consultative process for consideration at a future meeting of the Cabinet.
- iii) that due to the timescales involved the decision to issue this report for consultation be implemented prior to any consideration by the Governance and Scrutiny Committee under the call-in process, as to delay the decision would mean that the consultation could not be finalised before the end of the school session 2008/09.

10 May 2009

Graham Short
Executive Director of Educational and Social Services

THE SITE OF DARVEL NURSERY SCHOOL

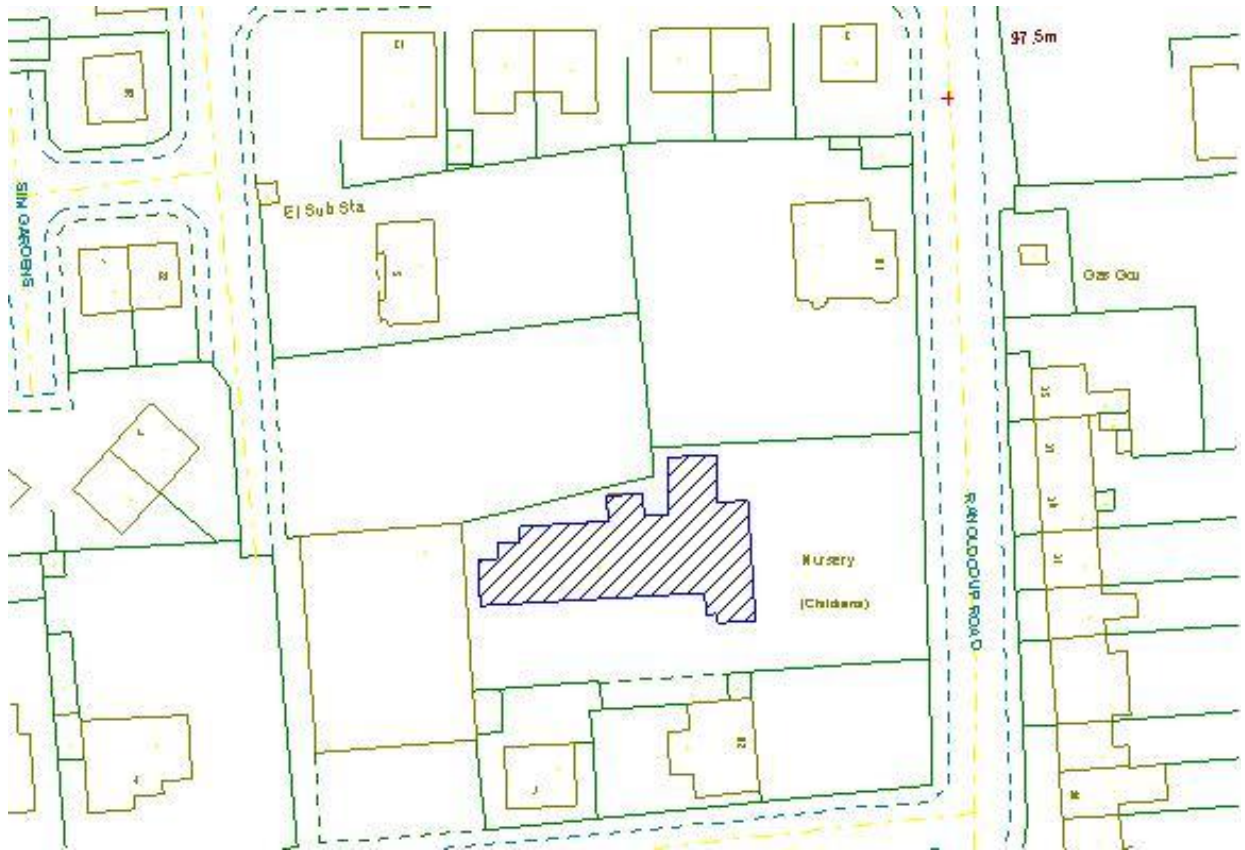

THE SITE OF DARVEL PRIMARY SCHOOL

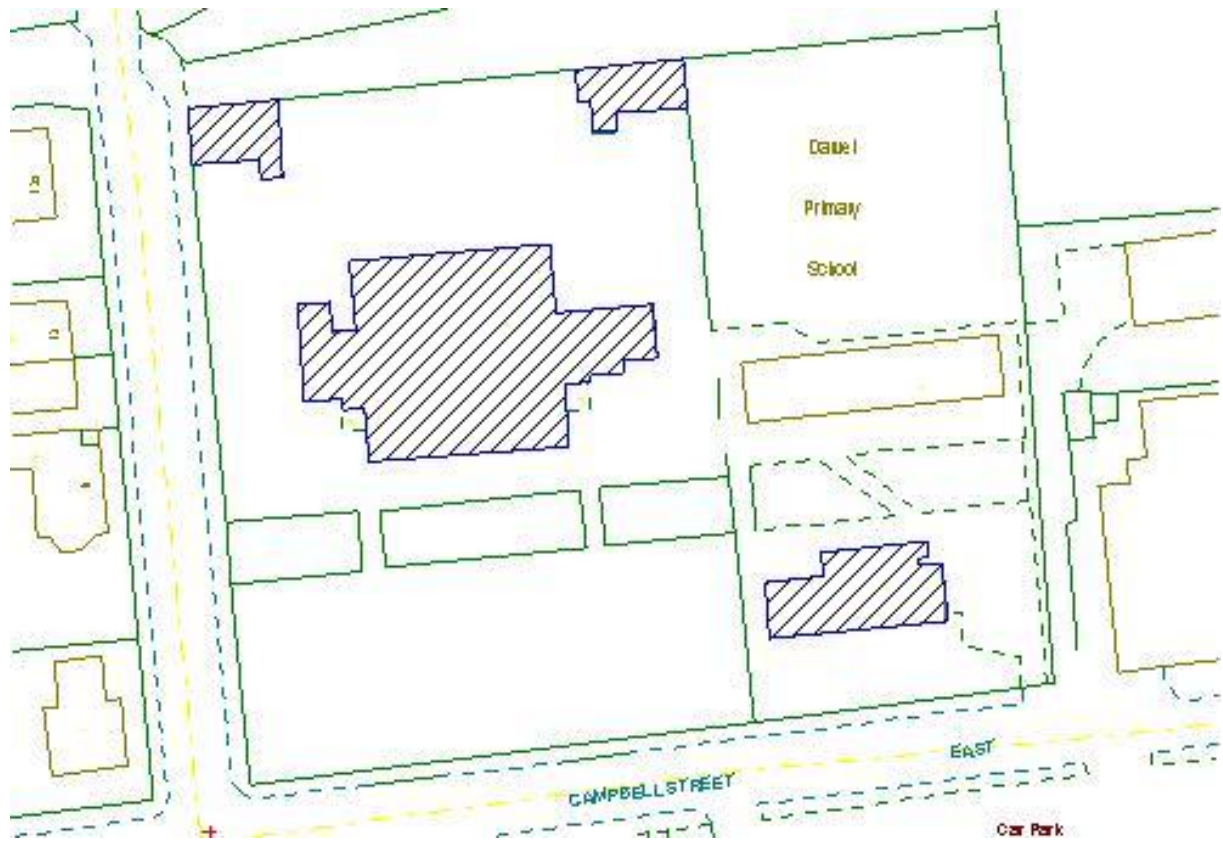

APPENDIX 4

Documentation Relevant to this Proposal

Education (Scotland) Act, 1980, as amended

Schools (Consultation) (Scotland) Act, 2009

Best Value and Community Planning Act, 2003

Schools Estate Management Plan, East Ayrshire Council

Capital Programme Update, Cabinet 6 May 2009



Department of Educational and Social Services

RESPONSE FORM

Office Use:

--

Proposals:

That pre-5 education at the existing Darvel Nursery School building be discontinued with effect from 30 June 2011, or as soon as possible thereafter.

Further, that Darvel Nursery School, staff and children should relocate to a new building to be constructed in the existing Darvel Primary School grounds, co-located with the refurbished primary school from 01 July 2011, or as soon as possible thereafter.

This part of the form must be completed for a valid response:

Name (please print)	Address
	Post Code
I agree/do not agree (delete which does not apply) that my response can be made publicly available	
Signature:	Date:

YOUR INTEREST: (please tick)

Darvel Nursery School	Darvel Primary School
Parent <input type="checkbox"/>	Parent <input type="checkbox"/>
Child/ young person <input type="checkbox"/>	Child/ young person <input type="checkbox"/>
Staff <input type="checkbox"/>	Staff <input type="checkbox"/>
Member of Community Council <input type="checkbox"/>	Member of Community Association <input type="checkbox"/>
Other: (please specify)	

Please state your views on the proposal (continue overleaf if necessary)

--